

3-Wege Flansch Kugelhahn | Flanschanschluss EN 1092-1 | Mit L-Bohrung oder T-Bohrung
DIN PN 16 * größere Druckstufen auf Anfrage
DIN DN 15 - 100* größere Nennweiten auf Anfrage

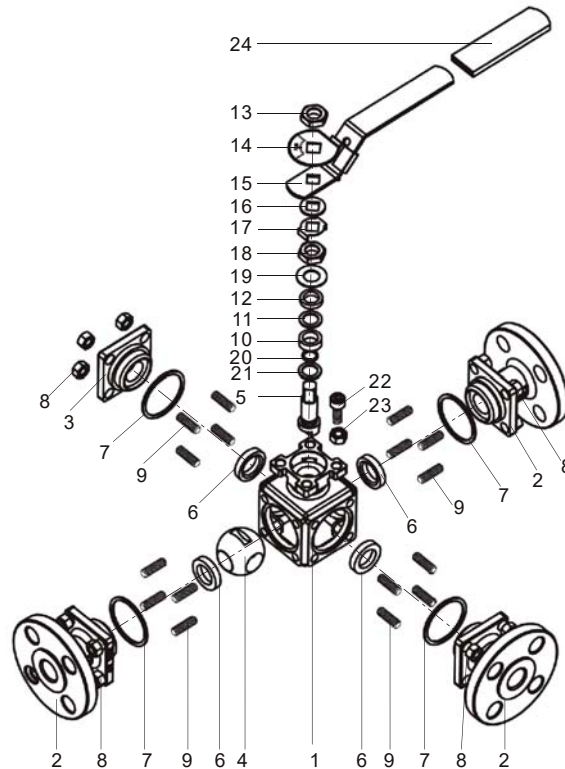

No.	Parts Name	Material		
		ANSI/DIN	ANSI/DIN	ANSI/DIN
1	Body	A216-WCB/1.0619	A351-CF8/1.4308	A351-CF8M/1.4408
2	Cap	A216-WCB/1.0619	A351-CF8/1.4308	A351-CF8M/1.4408
3	Blind plate	A216-WCB/1.0619	A351-CF8/1.4308	A351-CF8M/1.4408
4	Ball	A182-F304	A182-F304	A182-F316
5	Stem	A276-410	A276-304	A276-316
6	Seat	PTFE / PTFE+15%GF / PTFE+15%CF / TFM1600		
7	gasket	PTFE / RPTFE		
8	Nut	A194-2H	A194-8	A194-8
9	Stud	A193-B7	A193-B8	A193-B8
10	Packing	PTFE / RPTFE		
11	Wear washer	304+MoS2+PTFE	304+MoS2+PTFE	304+MoS2+PTFE
12	Gland	304	304	316
13	Nut	304	304	304
14	Indicator	304	304	304
15	Handle	304	304	304
16	Gasket	304	304	304
17	Lock washer	304	304	304
18	Nut	304	304	304
19	Disc spring	SS301	SS301	SS301
20	O-ring	Viton(FKM)	Viton(FKM)	Viton(FKM)
21	Thrust washer	PTFE/RPTFE	PTFE/RPTFE	PTFE/RPTFE
22	Screw	A193-B7	304	304
23	Nut	A194-2H	304	304
24	Handle cover	PVC	PVC	PVC

3-Wege Flansch Kugelhahn | Flanschanschluss EN 1092-1 | Mit L-Bohrung oder T-Bohrung

*DIN PN 16 * größere Druckstufen auf Anfrage*
DIN DN 15 - 100 größere Nennweiten auf Anfrage*

Design features

1. Stem O-ring + packing multiple seal.
2. Dynamic load pressure stem packing.
3. Blow-out proof stem.
4. Anti-static structure.
5. ISO 5211 standard actuator mounting pad.

Standard specification

1. Design: DIN 3357 /ASME B16.34
2. Face to Face: MFR STD
3. Flange End: EN 1092-1 /ASME B16.5
4. Inspection: EN 12266-1 /API 598

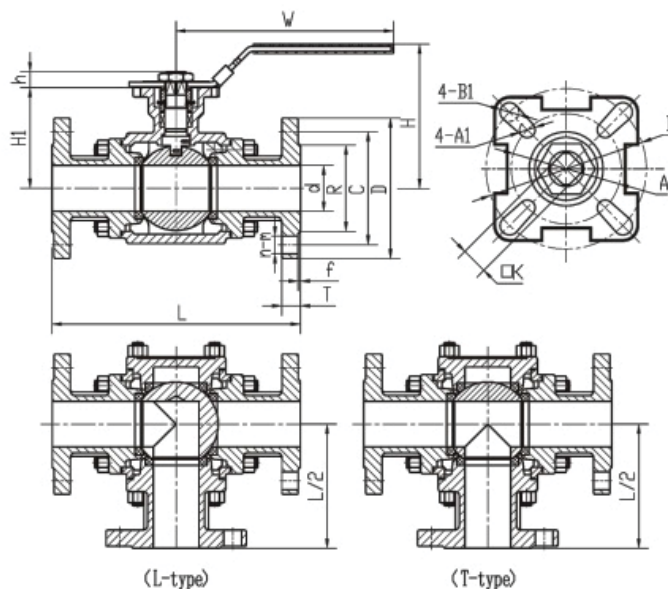

PN16																		
DN	Dimension				Flange dimension						Top connection size							
	d	L	H	W	D	C	R	T	f	n-m	ISO 5211	A	B	A1	B1	K	h	H1
15	15	175	88	162	95	65	45	16	2	4-14	F05	-	50	-	8	11	11	50.5
20	20	190	97	162	105	75	58	18	2	4-14	F05	-	50	-	8	11	11	59
25	25	210	117	187	115	85	68	18	2	4-14	F05/F07	50	70	8	10	14	14	78
32	32	230	120	187	140	100	78	18	2	4-18	F05/F07	50	70	8	10	14	14	83
40	38	250	147	233	150	110	88	18	3	4-18	F07/F10	70	102	10	12	17	17	100
50	49	265	154	233	165	125	102	18	3	4-18	F07/F10	70	102	10	12	17	17	107.5
65	63	280	171	318	185	145	122	18	3	8-18	F07/F10	70	102	10	12	22	22	120
80	76	320	183	318	200	160	138	20	3	8-18	F07/F10	70	102	10	12	22	22	132
100	100	370	242	460	220	180	158	20	3	8-18	F10/F12	102	125	12	14	27	27	170

CL150																		
NPS	Dimension				Flange dimension						Top connection size							
	d	L	H	W	D	C	R	T	f	n-m	ISO 5211	A	B	A1	B1	K	h	H1
1/2"	15	155	88	162	90	60.3	34.9	10	2	4-16	F05	-	50	-	8	11	11	50.5
3/4"	20	170	97	162	100	69.9	42.9	12	2	4-16	F05	-	50	-	8	11	11	59
1"	25	190	117	187	110	79.4	50.8	12.7	2	4-16	F05/F07	50	70	8	10	14	14	78
1 1/4"	32	210	120	187	115	88.9	63.5	14.5	2	4-16	F05/F07	50	70	8	10	14	14	83
1 1/2"	38	230	147	233	125	98.4	73	16	2	4-16	F07/F10	70	102	10	12	17	17	100
2"	49	265	154	233	150	120.7	92.1	17.5	2	4-19	F07/F10	70	102	10	12	17	17	107.5
2 1/2"	63	280	171	318	180	139.7	104.8	21	2	4-19	F07/F10	70	102	10	12	22	22	120
3"	76	320	183	318	190	152.4	127	22.5	2	4-19	F07/F10	70	102	10	12	22	22	132
4"	100	370	242	460	230	190.5	157.2	22.5	2	8-19	F10/F12	102	125	12	14	27	27	170