

2-Teiliger Flansch Kugelhahn | Baulänge Reihe 27 + Reihe 28
DIN PN 16 | 25 | 40
DIN DN 15 - 200

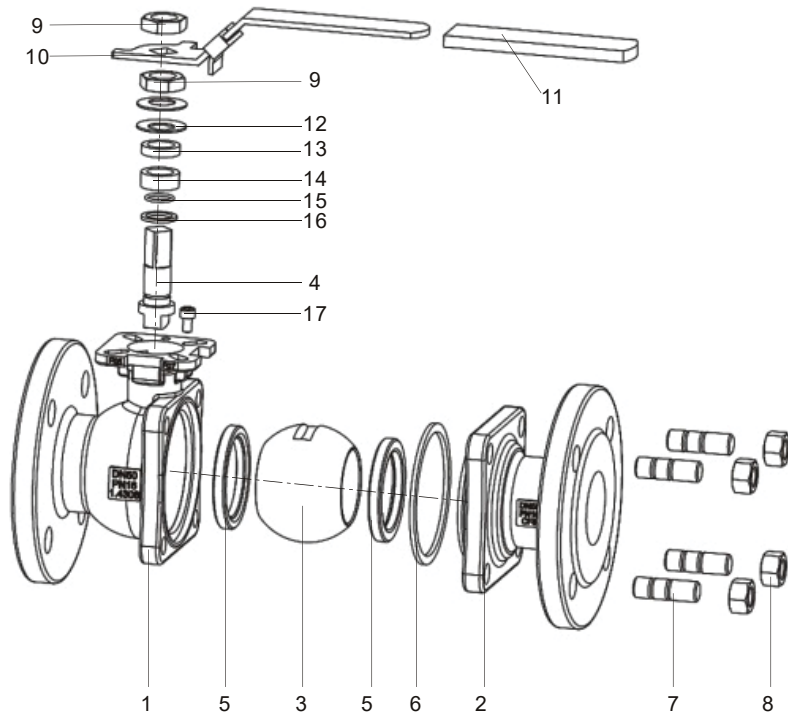

No.	Parts Name	Material		
		DIN/JIS/ANSI	DIN/JIS/ANSI	DIN/JIS/ANSI
1	Body	1.4308 /SCS13A/A351 CF8	1.4408 /SCS14A/A351 CF8M	1.0619 /SCPH2 /A216WCB
2	Cap	1.4308 /SCS13A/A351 CF8	1.4408 /SCS14A/A351 CF8M	1.0619 /SCPH2 /A216WCB
3	Ball	A182-F304	A182-F316	A182-F304
4	Stem	A276-304	A276-316	A276-410
5	Seat	PTFE / PTFE+15%GF / PTFE+15%CF / TFM1600		
6	gasket	PTFE/304+Graphite	PTFE/316+Graphite	PTFE/304+Graphite
7	Stud	A193-B8	A193-B8	A193-B7
8	Nut	A194-8	A194-8	A194-2H
9	Thin nut	304	304	304
10	Handle	304	304	304
11	Handle cover	PVC	PVC	PVC
12	Disc spring	SS301	SS301	SS301
13	Gland	304	316	304
14	Packing	PTFE/ Graphite		
15	O-ring	Viton(FKM)	Viton(FKM)	Viton(FKM)
16	Thrust washer	PTFE/RPTFE	PTFE/RPTFE	PTFE/RPTFE
17	Screw	304	304	304

2-Teiliger Flansch Kugelhahn | Baulänge Reihe 27 + Reihe 28

DIN PN 16 | 25 | 40
DIN DN 15 - 200

Design features

1. Stem O-ring + packing multiple seal.
2. Dynamic load pressure stem packing.
3. Blow-out proof stem.
4. Fire-proof and Anti-static structure.
5. Seat resilient seal design.
6. ISO 5211 standard actuator mounting pad.

Standard specification

1. Design: DIN 3357-2 EN 12516-1
2. Fire Design: API 607
3. Face to Face: EN 558 Series 27/1(L* Extended body)
4. Flange End: EN 1092-1
5. Inspection: EN 12266-1

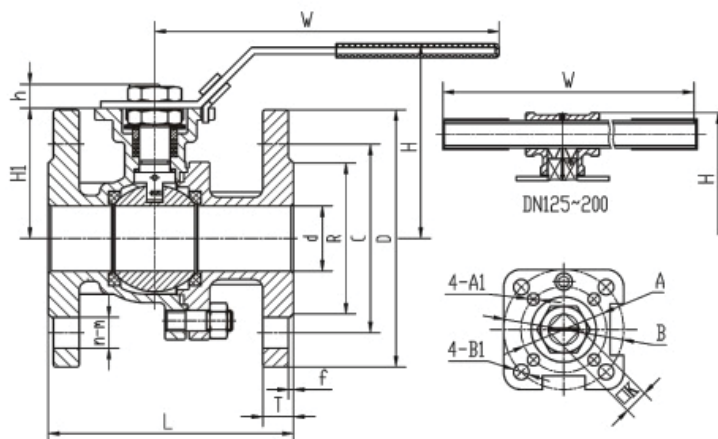

PN16/25/40																			
DN	Dimension					Flange dimension						Top connection size							
	d	L	L*	H	W	D	C	R	T	f	n-m	ISO 5211	A	B	A1	B1	K	h	H1
15	15	115	130	80	141	95	65	45	16	2	4-14	F03/F04	36	42	6	6	9	9	48
20	20	120	150	86	141	105	75	58	18	2	4-14	F03/F04	36	42	6	6	9	9	54
25	25	125	160	98	162	115	85	68	18	2	4-14	F04/F05	42	50	6	7	11	11	61
32	32	130	180	107	162	140	100	78	18	2	4-18	F04/F05	42	50	6	7	11	11	70
40	38	140	200	114	220	150	110	88	18	3	4-18	F05/F07	50	70	7	9	14	14	76
50	50	150	230	123	220	165	125	102	20	3	4-18	F05/F07	50	70	7	9	14	14	85

PN16																			
DN	Dimension					Flange dimension						Top connection size							
	d	L	L*	H	W	D	C	R	T	f	n-m	ISO 5211	A	B	A1	B1	K	h	H1
65	64	170	290	154	285	185	145	122	18	3	4-18	F07/F10	70	102	9	11	17	17	108
80	76	180	310	166	285	200	160	138	20	3	8-18	F07/F10	70	102	9	11	17	17	122
100	100	190	350	196	380	220	180	158	20	3	8-18	F10	-	102	-	11	22	22	148
125	123	325	-	260	705	250	210	188	22	3	8-18	F12	-	125	-	14	27	30	180
150	150	350	-	285	705	285	240	212	22	3	8-22	F12	-	125	-	14	27	30	202
200	200	400	-	345	1200	340	295	268	24	3	12-22	F12/F14	125	140	13	18	30	32	258

PN25/40																			
DN	Dimension				Flange dimension						Top connection size								
	d	L	H	W	D	C	R	T	f	n-m	ISO 5211	A	B	A1	B1	K	h	H1	
65	64	170	163	285	185	145	122	22	3	8-18	F07/F10	70	102	10	11	17	17	108	
80	76	180	172	285	200	160	138	24	3	8-18	F10	-	102	-	11	22	22	130	
100	100	190	201	380	235	190	162	24	3	8-22	F10	-	102	-	11	22	22	148	
125	123	325	260	705	270	220	188	26	3	8-26	F12	-	125	-	14	27	30	180	
150	150	400	310	1200	300	250	218	28	3	8-26	F12/F14	125	140	13	18	30	32	222	