

Cast Steel Gate Valve

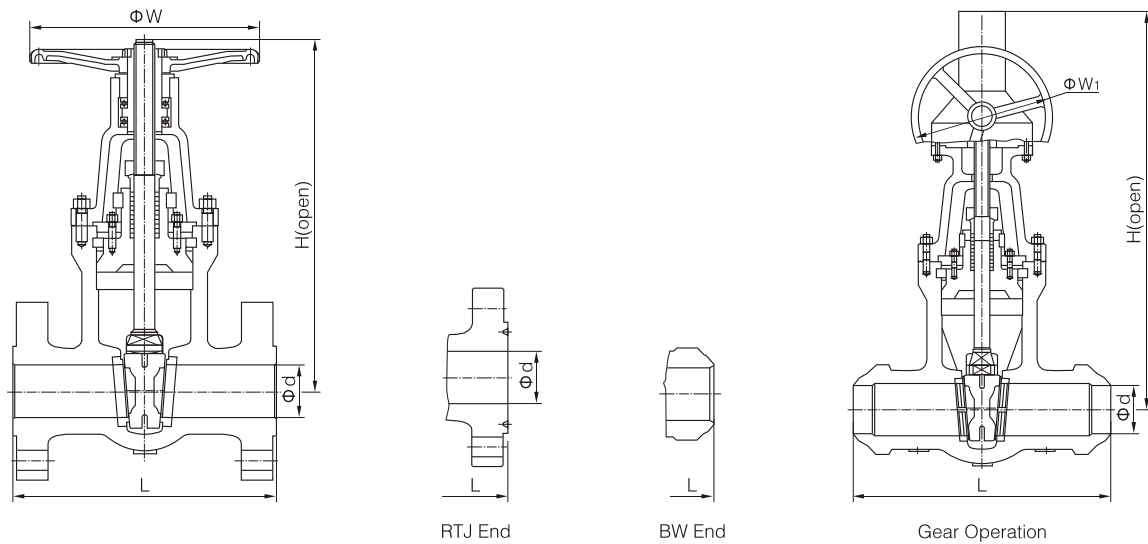

| Class | Size | | Dimensions(mm) | | | | | | | Weight(kg) | | |
|------------|-------|------|----------------|------|------|-----|------|----------------|-----|----------------|------|------|
| | NPS | DN | L | | | d | H | H ₁ | W | W ₁ | H.W | G.O |
| | | | RF | RTJ | BW | | | | | | | |
| Class 2500 | 2 | 50 | 451 | 454 | 451 | 42 | 530 | 580 | 280 | 310 | 100 | 130 |
| | 2 1/2 | 65 | 508 | 514 | 508 | 52 | 580 | 630 | 300 | 310 | 150 | 180 |
| | 3 | 80 | 578 | 584 | 578 | 62 | 650 | 700 | 350 | 310 | 245 | 275 |
| | 4 | 100 | 673 | 683 | 673 | 87 | 750 | 800 | 400 | 310 | 390 | 420 |
| | 5 | 125 | 794 | 807 | 794 | 96 | 900 | 960 | 500 | 460 | 550 | 580 |
| | 6 | 150 | 914 | 927 | 914 | 131 | 1040 | 1100 | 600 | 460 | 780 | 835 |
| | 8 | 200 | 1022 | 1038 | 1022 | 179 | 1150 | 1200 | 750 | 460 | 1260 | 1355 |
| | 10 | 250 | 1270 | 1292 | 1270 | 223 | 1400 | 1460 | 900 | 600 | 2380 | 2565 |
| 12 | 300 | 1422 | 1445 | 1422 | 265 | - | 1660 | - | 600 | - | 3250 | |

Cast Steel Gate Valve

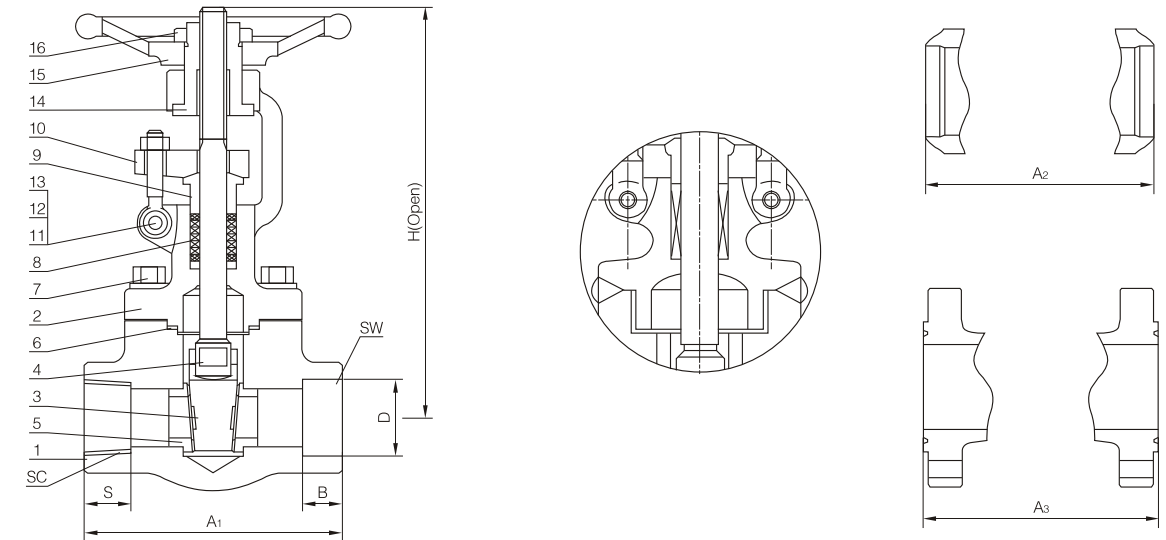

Technical Specification

- ★ Steel Gate Valves, API 602
- ★ Steel Valves, ASME B16.34
- ★ Face to Face, Manufacturer Standard
- ★ Face to Face, Flanged, ASME B16.10
- ★ End Flanges, ASME B16.5
- ★ Buttwelding Ends, ASME B16.25
- ★ Socket-welding Ends, ASME B16.11
- ★ Screwed Ends, ASME B1.20.1
- ★ Inspection and Test, API 598

Design Description

- ▲ Outside Screw and Yoke (OS&Y)
- ▲ Bolted Bonnet
- ▲ Choice of WB, Welding Bonnet
- ▲ Single Wedge, Fully Guided
- ▲ Renewable Seat Rings
- ▲ Yoke Integral with Bonnet
- ▲ Rising Stem and Non-rising Handwheel
- ▲ SW, Socket-welding Ends
- ▲ SC, Screwed Ends
- ▲ BW, Buttwelding Ends
- ▲ Flanged Ends

Form of Major Part Material

| No. | Part Name | ASTM Material | | | | | | | | |
|-----|-------------------------------------|----------------|----------------|----------------|-----------------|-----------------|-----------------|-----------------|-----------------|--|
| | | Carbon Steel | 1.25Cr-0.5Mo | 2.25Cr-1Mo | 304 Type | 316 Type | 304L Type | 316L Type | 20 Alloy | |
| 1 | Body | A105 | A182 F11 | A182 F22 | A182 F304 | A182 F316 | A182 F304L | A182 F316L | 20-Alloy | |
| 2 | Bonnet | A105 | A182 F11 | A182 F22 | A182 F304 | A182 F316 | A182 F304L | A182 F316L | 20-Alloy | |
| 3 | Wedge | A105+13Cr *1 | A182 F11+HF | A182 F22+HF | A182 F304 | A182 F316 | A182 F304L | A182 F316L | 20-Alloy | |
| 4 | Stem | A182 F6a | A182 F11 | A182 F22 | A182 F304 | A182 F316 | A182 F304L | A182 F316L | 20-Alloy | |
| 5 | Seat Ring | A105+13Cr *1 | A182 F11+HF | A182 F22+HF | NA | NA | NA | NA | Na | |
| 6 | Bonnet Gasket | 304+Graphit | 304+Graphit | 304+Graphit | 304+Graphit | 316+Graphit | 304L+Graphit | 316L+Graphit | 316+Graphit | |
| 7 | Bonnet Bolt | A193 B7 | A193 B7 | A193 B16 | A193 B8 | A193 B8M | A193 B8M | A193 B8M | A193 B8M | |
| 8 | Packing | Graphite | Graphite | Graphite | Graphite *2 | Graphite *2 | Graphite *2 | Graphite *2 | Graphite *2 | |
| 9 | Gland | A276 410 | A276 410 | A276 410 | A276 304 | A276 316 | A276 304L | A276 316L | 20-Alloy | |
| 10 | Gland Flange | A105 | A105 | A105 | A182 F304 | A182 F316 | A182 F304L | A182 F316L | 20-Alloy | |
| 11 | Eyebolt | Carbon Steel | A193 B7 | A193 B7 | A193 B8 | A193 B8 | A193 B8 | A193 B8 | A193 B8 | |
| 12 | Eyebolt Nut | Carbon Steel | A194 2H | A194 2H | A194 8 | A194 8 | A194 8 | A194 8 | A194 8 | |
| 13 | Eyebolt Pin | A276 410 | A276 410 | A276 412 | A276 304 | A276 304 | A276 304 | A276 304 | A276 304 | |
| 14 | Stem Nut | Bronze | Bronze *3 | Bronze *3 | Bronze | Bronze | Bronze | Bronze | Bronze | |
| 15 | Hand wheel | Malleable iron | Malleable iron | Malleable iron | Malleable iron | Malleable iron | Malleable iron | Malleable iron | Malleable iron | |
| 16 | Wheel Nut | Carbon Steel | Carbon Steel | Carbon Steel | Carbon Steel+Zn | Carbon Steel+Zn | Carbon Steel+Zn | Carbon Steel+Zn | Carbon Steel+Zn | |
| *1 | PN ≥ 600 Class seal face will be HF | | | | | | | | | |
| *2 | PTFE Optional | | | | | | | | | |
| *3 | Ductile Ni-Resist iron Optional | | | | | | | | | |